

SWING CHECK VALVE LEVER AND WEIGHT 4" & 6"

MODEL 92LW - Class #125

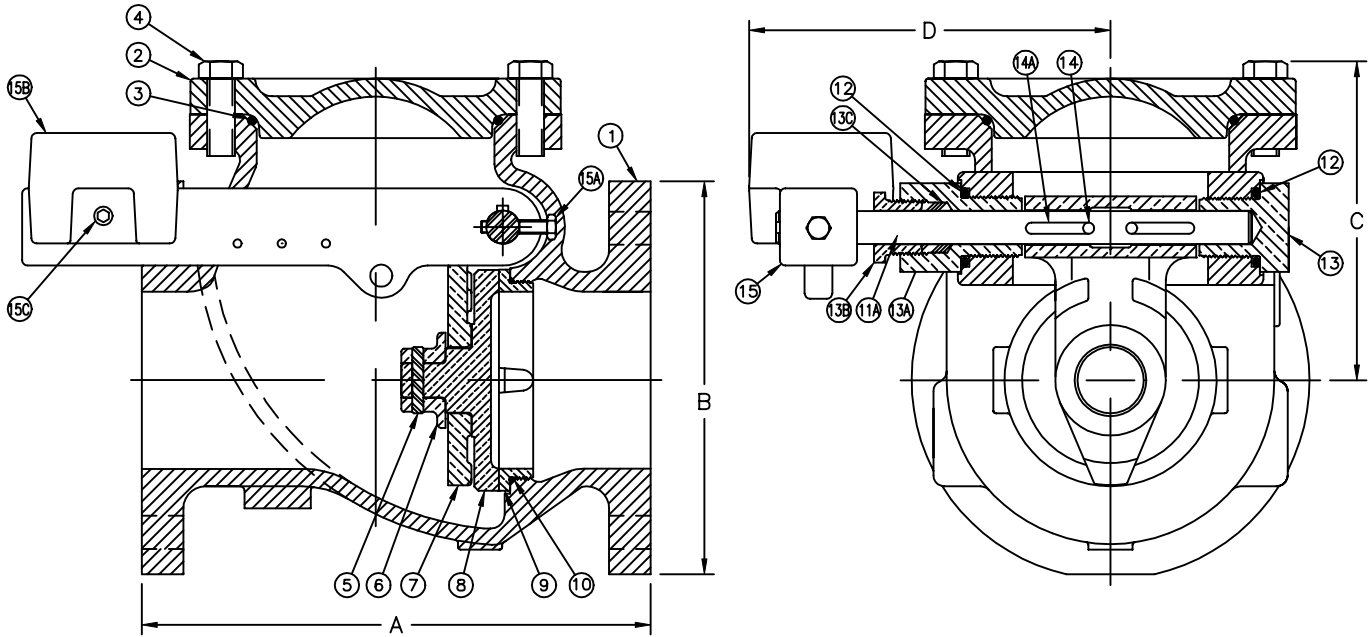

* OPTIONAL RESILIENT SEAT (NITRILE) AVAILABLE, ADD "R" TO THE PART NUMBER
FOR REFERENCE USE ONLY, SPECIFICATIONS SUBJECT TO CHANGE WITHOUT NOTICE.

SIZE(in.)	PART No.	A	B	C	D	WT. lbs.
4	3707LW	11-1/2	8-57/64	7-7/32	8-3/16	109
6	3709LW	14	10-3/4	8-17/32	9-7/32	195

ITEM	QTY.	DESCRIPTION	MATERIAL	ASTM #
1	1	BODY (EPOXY COATED)	CAST IRON	A126 CLASS B
2	1	COVER (EPOXY COATED)	CAST IRON	A126 CLASS B
3	1	COVER O-RING	BUNA-N	-----
4	4	COVER BOLTS	STAINLESS STEEL	18-8
5	1	FLAPPER END CAP PIN	STAINLESS STEEL	18-8
6	1	FLAPPER END CAP	FEDERALLOY	I-836-FL
7	1	HINGE LEVER ARM	FEDERALLOY	I-836-FL
8	1	*FLAPPER PLATE	FEDERALLOY	I-836-FL
9	1	SEAT RING	FEDERALLOY	I-836-FL
10	1	O-RING	BUNA-N	-----
11A	1	FLAPPER SUPPORT SHAFT	STAINLESS STEEL	17-4
12	2	O-RING	BUNA-N	-----
13	1	SHAFT SUPPORT BEARING	BRONZE	C93200
13A	1	OPEN ENDED SHAFT BEARING	BRONZE	C93200
13B	1	PACKING NUT	BRONZE	C93200
13C	4	PACKING	TEFLON	-----
14	1	1/4 -20 ALLEN HD SCREW	STAINLESS STEEL	18-8
14A	3	1/4" KEYS	STAINLESS STEEL	302
15	1	LEVER ARM (EPOXY COATED)	DUCTILE IRON	A536-84
15A	1	LEVER SCREW	STAINLESS STEEL	18-8
15B	1	WEIGHT (EPOXY COATED)	CAST IRON	A126 CLASS B
15C	1	WEIGHT SCREW	STAINLESS STEEL	18-8